

**SECTION B - B**  
**DETAIL OF CONNECTION BETWEEN FLEXIBLE AND RIGID PAVEMENT**  
 1 : 25

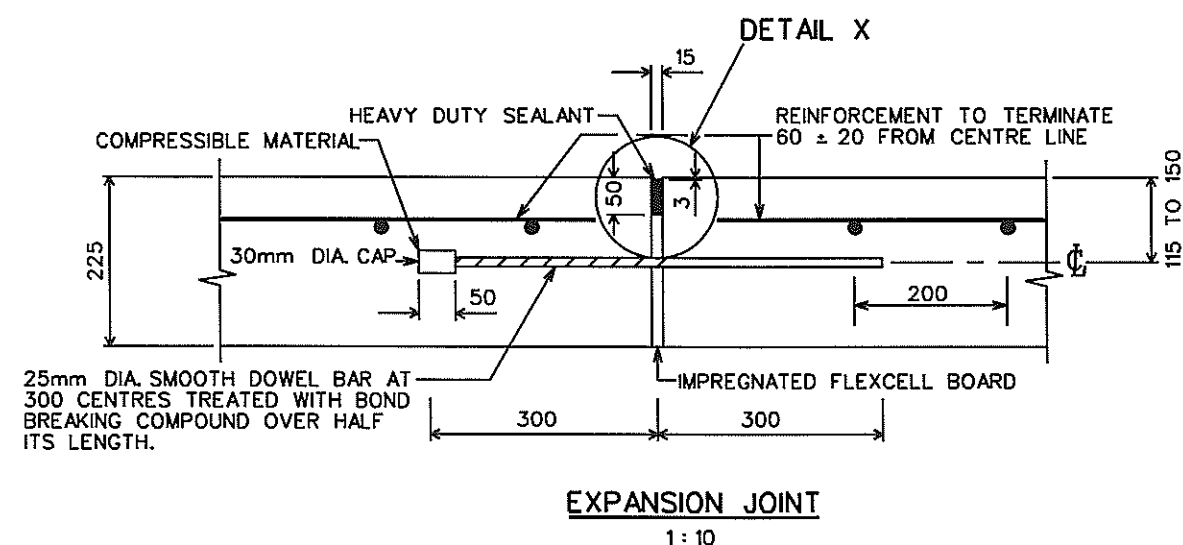
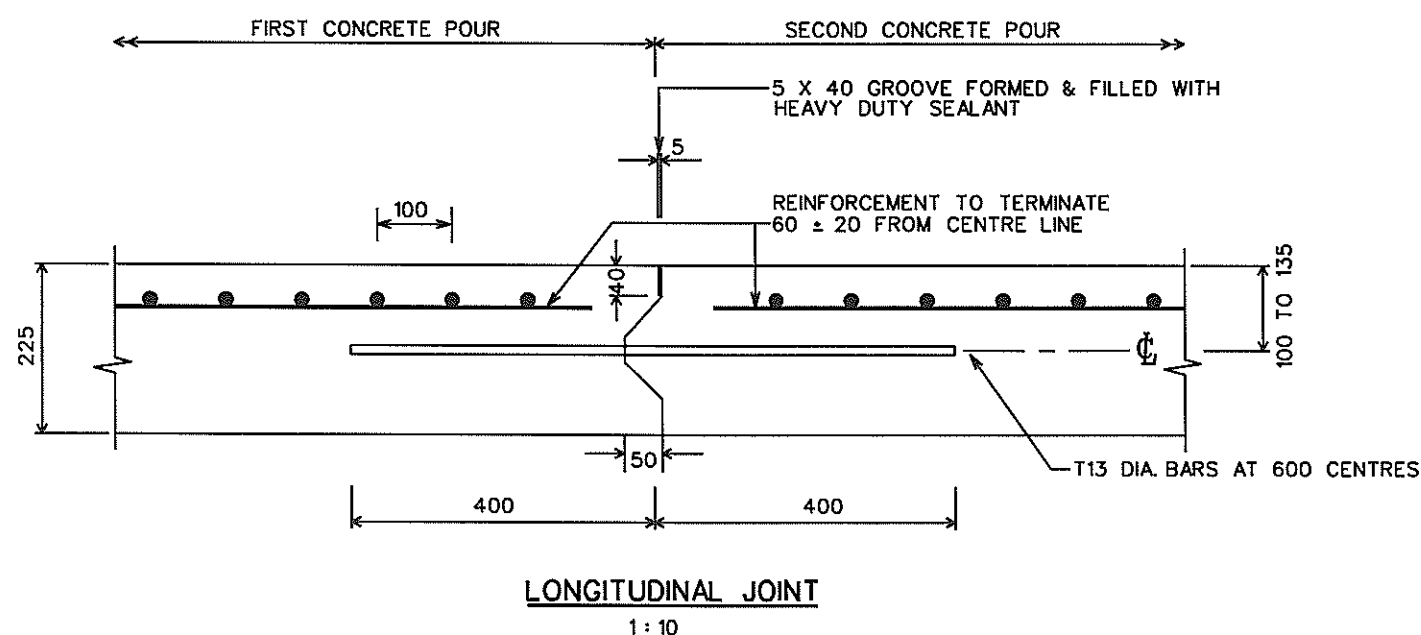
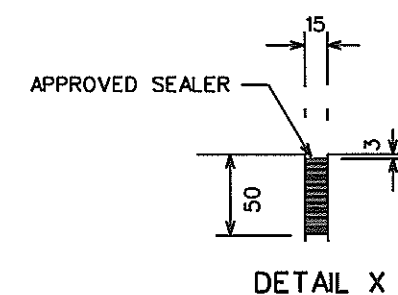

**NOTES:-**

1. BOND BREAKING COMPOUND  
 66% LIGHT 200 PEN BITUMEN + 14% LIGHT CREOSOTE OIL +  
 20% SOLVENT NAPHTHA
2. THE CONCRETE SHALL BE OF GRADE 35.
3. THE CONCRETE COVER SHALL BE 40mm.

DATE OF REVISION

A. 05-05-2008

STANDARD DETAIL

RIGID PAVEMENT

Land Transport Authority

DRAWING NO.

LTA/RD/SD99/PAV/6A

DATE OF ISSUE  
 APR 2000

SCALE  
 AS SHOWN

SHEET NO.  
 2 OF 2